

# Tiger DR-RP Podiatry

Acquire | Store | View | Share

## Premium Gadox 12x12 & 14x17 Flat Panel Retrofit System



### The Industry Leading DR Upgrade for Image Quality

Tiger DR-RP is the industry leading **GADOX** flat panel imaging solution for the podiatry market, which allows podiatrists a smart and cost-effective way to upgrade their current x-ray systems.



4.5 lbs for 12x12, 6 lbs for 14x17

Tiger DR-RP comes with a single handle detector encasement that is designed for increased maneuverability and durability. Our specialized encasement has been designed to fit exclusively into our universal retrofit orthoposer, which allows for simple and easy integration with most x-ray models from leading manufacturers like X-Cel X-Ray, MinXray and Poskom. At only 3.5" tall, it's simple to position patients for every view.



Panel available tethered or wireless



6 second image acquisition time

TigerView is a podiatry-specific PACS software that understands the needs of the practitioner and has been developed with 30+ different podiatry measurements. Comprehensive AP and Lateral tool sets provide for quick and efficient patient diagnosis. Enjoy improved workflow with our user-friendly software.



Directly integrates with TigerView software



No cassettes necessary

Standard TigerView Retrofit packages include:

- ADA compliant ortho-base
- Ergonomic panel encasement
- 23" computer
- TigerView Podiatry PACS software
- Five viewing software licenses
- Bridges to EMR, EHS & PMS
- On-site install and training



2 year x-ray Electrical  
5 year x-ray Mechanical  
4 year panel warranty

Call us for an in-office demo today.

**1-800-385-9593**



# Tiger DR-RP Podiatry

## Premium Gadox 12x12 & 14x17 Flat Panel Detector System

### SPECIFICATIONS

Sensor		Environmental	
Sensor	a-Si TFT Array	Operating	
Conversion Screen	CsI: TI / Premium Gadox	Temperature Range	10 - 35°C
Image Data	16 bits	Humidity Range (non-condensing)	20% - 75% RH
Limiting Resolution	3.5 lp/mm	Storage	
12x12 Active Area	12x12 (287x287mm)	Temperature Range	-10°C - 60°C
14x17 Active Area	14x17 (350x430mm)	Humidity Range	10% - 90% RH
12x12 Sensor Pixel	2048x2048	Water / Dust Proof	IP64
14x17 Sensor Pixel	2560x3072	Mechanical	
Image Quality		12x12 Dimensions	308.5x319.5x15mm
Data Transfer Time	Less than 1 second	14x17 Dimensions	385x460x15mm
12x12 Internal Storage	Up to 200	12x12 Weight	4.4 lbs w/battery
14x17 Internal Storage	Up to 150	14x17 Weight	6 lbs w/battery
Communication Interface		Power	
Image Acquisition Time	3-5 sec. (approx)	Battery Performance	10 hours
Trigger Mode	AED (Auto Exposure Detection), Manual Trigger	AC Power	
Calibration Mode	ACC (Auto Calibration Control), Manual Calibration	Power Supply	100 - 240V AC
Image Transmission	Gigabit Wi-Fi IEEE 802.11	Frequency	50/60 Hz

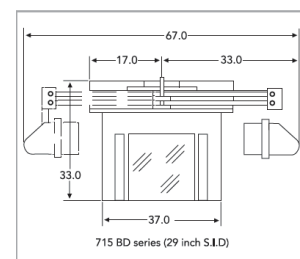

For complete product information, visit [televeresystems.com](http://televeresystems.com)